

Operation Manual

Installation Steps

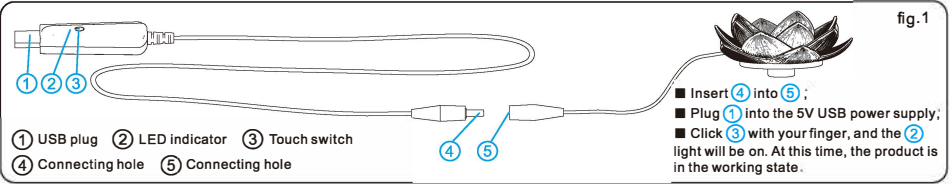

1. First let the product be in working condition



2. Soak 6 in water for 10 seconds.

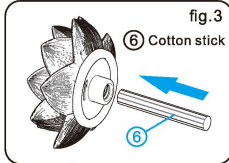

3. Insert 6 into the bottom hole of lotus.

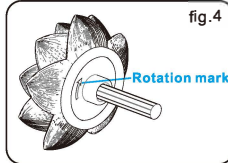

4. Find the "rotation mark" on the back of the lotus.

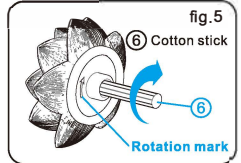

5. Rotate 6 2-3 full turns in the direction of "rotation mark".

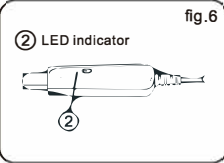

6. Please confirm that 2 shows blue light or green light .



7. You will see the fog coming out. If there is no fog, please rotate the cotton stick again according to fig.5 .

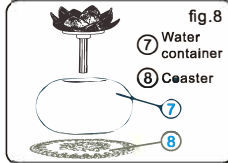

8. Fill 7 with about 80% water.
9. Put 7 on 8 .
10. Put the lotus on 7 .



11. The final form (The water containers of different models will be different, it is subject to the actual object) .

A solution with less spray after a period of time

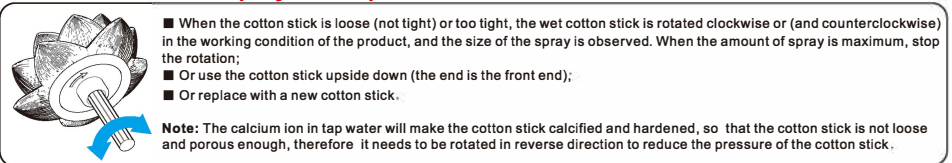

Method of replacing cotton stick

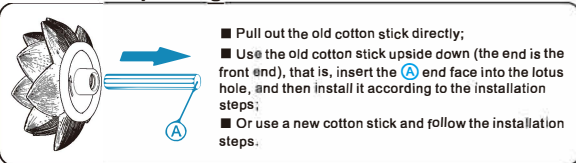

Solution to enabling the table wet or too large spray

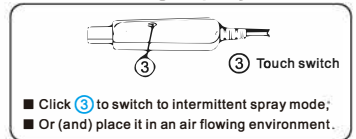

Shift the working mode, click the touch switch to shift the working mode:

- First click: Blue light, it will automatically turn off after 10 hours of continuous work;
 - Second click: Green light, automatically shut down after 6 hours of continuous work;
 - Third click: Red light, interval (spray for 3 seconds, stop for 2 seconds) automatically shut down after 16 hours of work;
 - Fourth click: Off light, and the machine is turned off immediately.
- So cycle.

● **Note:** press and hold the touch switch for 2 seconds to turn off the LED indicator independently. At this time, the working mode of the product does not change.

Main materials: Ceramics, TPE, PP.
Rated voltage and maximum power: DC5V, 2W.
Water capacity: 200ml, effective coverage area of the product < 60m².
Including: 1" diffuser, 1" USB cable, 2" cotton stick.
Suitable working environment: 5-40 °C, relative humidity < 80%.
Water type: clear water.

Note:

1. If this product is not used for a long time, please clean the cotton stick, spray outlet and container before storage and keep them dry.
2. Plug the USB plug of the product into the mobile phone charger adapter, computer USB port or mobile power supply.
3. Please do not put it in any narrow position in the state of spray. Do not cover it. Otherwise, dew will wet your table.