

Malfunction		
Promble	Reason	solution
When the remote controller's power ON button is pressed, the unit is not running.	Plug is not connected to power or not connected properly	Plug the AC adapter plug into the power supply properly
	AC adapter connector does not properly connect with the product plug	Plug the AC adapter plug into the power supply properly
	Remote control distance is too far	Remote control please stay within 3 meters of the product.
	The remote controller does not have a body-facing remote sensor.	Please place the remote controller facing the remote sensor
No spray Difficult to spray	The use of purified water or distilled water.	Please use tap or mineral water
	Water below the water level sensor, or above the water level line	Please control the amount of water in the water tank above the water level sensor, below the water level line.
	Ultrasonic fog chip partially dirty	Please follow the instructions P9 for cleaning methods for cleaning
	Use on soft objects such as carpets or in places where the wind speed is too fast	Please use in a stable place and temperature without wind
Can't play music	Remote control music button is OFF.	Please set the remote music button to ON.
	Connected radio	Disconnect the radio
	Status: Stopped	Please turn off the power and confirm to run again

If you still have an abnormality after confirming the above exclusion, please go to the place of purchase to consult. Please do not disassemble or repair the product yourself .

<b>Product name</b>	Solid wood music Aroma Ultrasonic Diffuser
<b>Mist Volume</b>	25 ml/hr
<b>Water Tank Capacity</b>	150ml
<b>Dimension</b>	φ172mm*128mm
<b>Weight</b>	500g
<b>Rated Voltage</b>	AC100V-AC240V 50/60HZ/24V 500mA

## Solid wood music Aroma Ultrasonic Diffuser

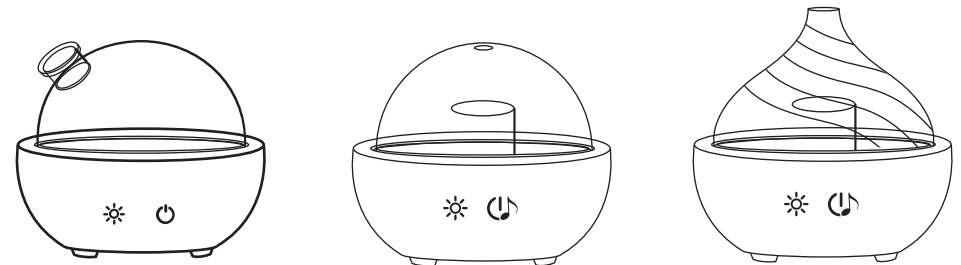

## Manual

To ensure safety, please read this manual carefully before installation and follow the instructions herein. Store this manual in a secure place for future reference.

## Machine composition

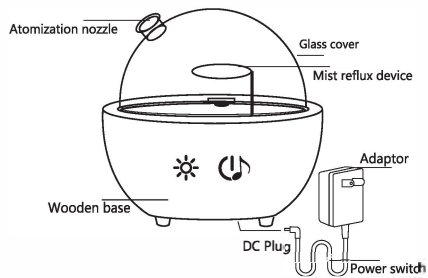

Front view

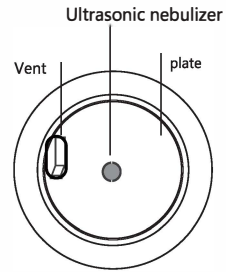

Top view

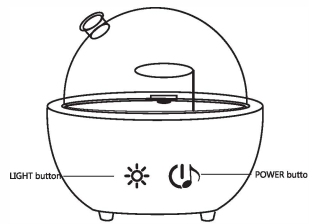

Back view

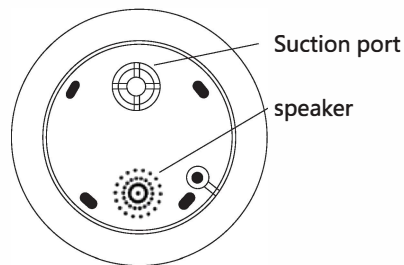

## How to use your Radha Diffuser

1. Open the glass cover.
2. Using clean water, add 120ml of water to the bowl up to fill line. (DO NOT over fill.)  
(In case of pouring a large amount of liquid into the crack, please extract the plug and reverse the main engine so that it can be dried.)
3. Add 6-8 drops of your favorite essential oil to the water.
4. Cover the glass cap.
5. Put the glass nozzle in.
6. Plug in the power.
7. Turn on the power switch.
8. **Mist settings:** For continuous misting, tap right POWER button once. For intermittent misting, tap right POWER button twice.
9. **LED settings:** For alternating lights, tap left LIGHT button once. Continue tapping left LIGHT button to select color.

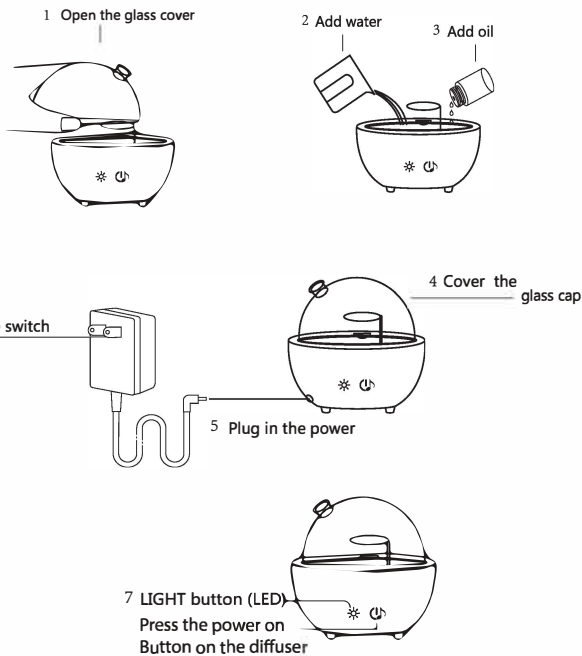

## function

### About atomization:

1. Short press one time for continuous spray.
2. Short press second time for intermittent spray, spray 10 seconds and stop to spray 10 seconds continuously.
3. Press third time for Shut down.
4. Long press music switch key for switching the atomization volume.

### About lighting:

- The first pressing for seven colors cycle light.
- Pressing from second time to the eighth times is to select the corresponding light
- The ninth press for stop its working.

### Notice

- DO NOT add more than 150ml or over the fill line.
- Make sure device is off and has cover on prior to turning on.
- DO NOT open glass cover or touch water while device is on.

