

DEVANTI®

Instruction Manual

High performance cordless
handheld Vacuum Cleaner

Model:
VAC-CL-H-C9-GR

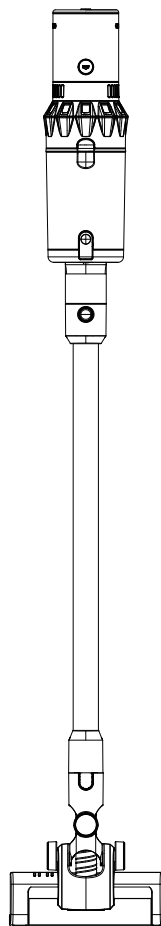

Please read the manual carefully before
operating your vacuum cleaner.
Retain it for future reference.
Important safety Instructions

Important Safety Instructions

WARNING: Basic safety precautions should always be observed when using an electrical appliance, including the following to reduce the risk of fire, electrical shock, or injury.

Personal Safety

- 1.Store it indoors in a dry place out of the reach of children;
- 2.Always use responsibly. This appliance can be used by children aged from 10 years and above and persons with reduced physical, sensory or mental capabilities or lack of experience and knowledge if they have been given supervision or instruction concerning use of the appliance in a safe way and understand the hazards involved;
- 3.Don't let children play with the appliance; supervise children using or maintaining the appliance;
- 4.Use only manufacturer's recommended attachments as described in this manual; misuse or use of any accessory or attachment other than those recommended, may present a risk of personal injury;
- 5.Take extra care when cleaning stairs;
- 6.Keep the appliance and accessories away from hot surface;
- 7.Do not block the appliances openings or hinder air flow, keep openings free of any objects including dust, lint, clothing, fingers (and all parts of the body);
- 8.Particularly keep hair away from openings and moving parts;

Electrical Safety

- 1.Only use batteries and chargers supplied by the manufacturer;
- 2.Never modify the charger in any way;
- 3.The charger has been designed for a specific voltage. Always check that the voltage is the same as that stated on the rating plate;
- 4.A charger that is suitable for one type of battery pack may create a risk of fire when used with another battery pack;
- 5.Before using, check the charger cord for signs of damage or ageing. A damaged or entangled charger cord increases the risk of fire and electric shock;

Electrical Safety

6. Don not abuse the charger cord;
7. Never carry the charger by the cord;
- 8, Do not pull the cord to disconnect it from a socket, grasp the plug and pull to disconnect it;
9. Don't wrap the cord around the charger when storing;
10. Keep the charger cord away from hot surfaces and sharp edges;
11. The supply cord cannot be replaced. If the cord is damaged the charger should be discarded and replaced.
12. Do not handle the charger or the appliance with wet hands;
13. Do not store or charge the appliance outdoors;
- 14, The charger must be removed from the socket before removing the battery, cleaning or maintaining the appliance.

Battery Safety

1. This appliance includes Li-ion batteries, do not incinerate batteries or expose to high temperatures, as they may explode;
2. Liquid ejected from the battery may cause irritation or burns;
3. In an emergency situation contact professional help immediately;
4. Leaks from the battery cells can occur under extreme conditions. Do not touch any liquid that leaks from the battery. If the liquid that gets on skin, wash immediately with soap and water. If the liquid gets into the eyes, flush them immediately with clean water for a minimum of 10 minutes and seek medical attention. Wear gloves to handle the battery and dispose of immediately in accordance with local regulations;
5. Shorting the battery terminals may cause burns or fire;
6. When the battery pack is not in use, keep it away from paper clips, coins, keys, nails, screws or other small metal objects that could make a connection from one terminal to another.
7. When you dispose of the appliance remove the battery and dispose of the battery safely in accordance with local regulations.

Service

1. Before using the appliance and after any impact, check for signs of wear or damage and repair as necessary;
2. Do not use the appliance if any part is damaged or defective;
3. Repairs should be carried out by a service agent or a suitably qualified person in accordance with relevant safety regulations. Repairs by unqualified persons could be dangerous;
4. Never modify the appliance in any way as this may increase the risk of personal injury;
5. Only use replacement parts or accessories provided or recommended by manufacturer.

Intended Use

1. This appliance has been designed for domestic dry vacuum cleaning only;
2. Do not pick up liquids or use on wet surfaces;
3. Do not pick up anything that is flammable, burning or smoking;
4. Use only as described in this manual;
5. Don't use on concrete, tarmac or other rough surfaces.

Warning

1. Do not use water, solvents, or polishes to clean the outside of the appliance; wipe clean with a dry cloth;
2. Never immerse the unit in water and do not clean in a dish washer.

Introduction of Components

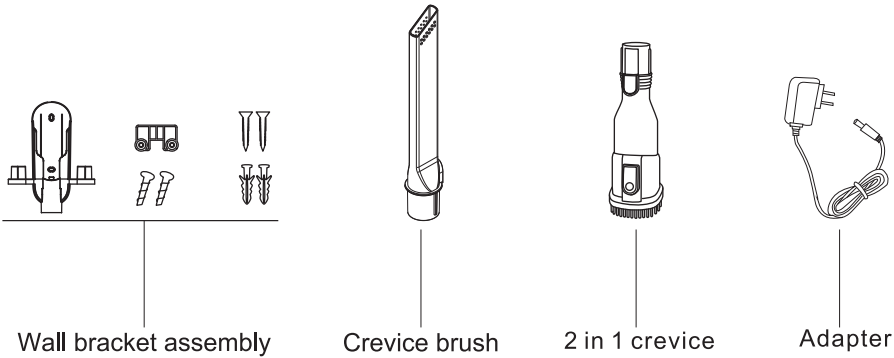
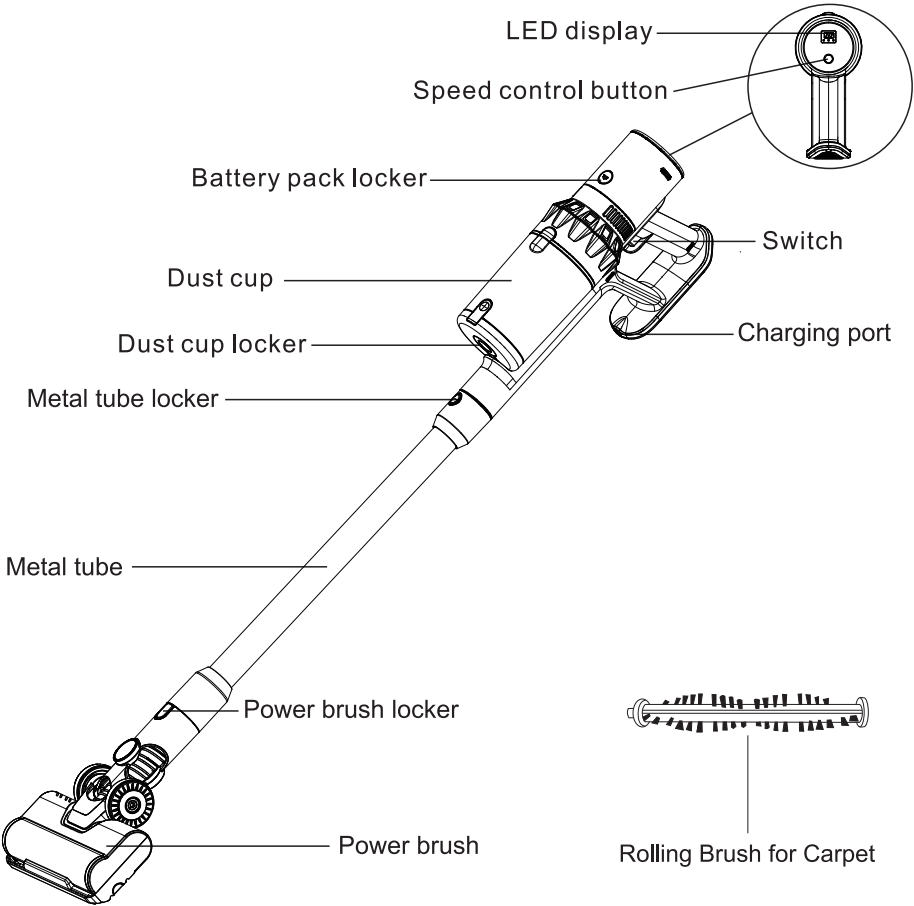

Product Installment

I. Use as the stick vacuum cleaner

a) Assemble the battery pack to mainbody until hear click sound.

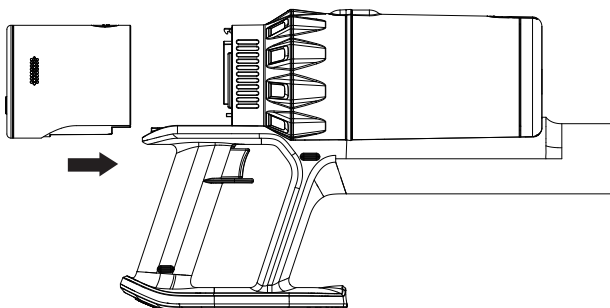

b) Attach the metal tube to the body as below until hear click sound.

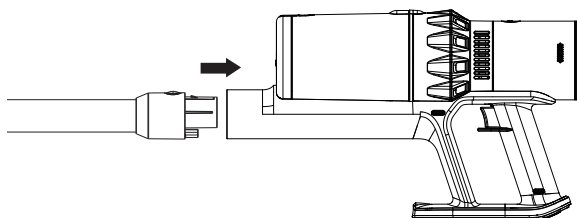

c) Attach the brush to another head of the tube as showed.

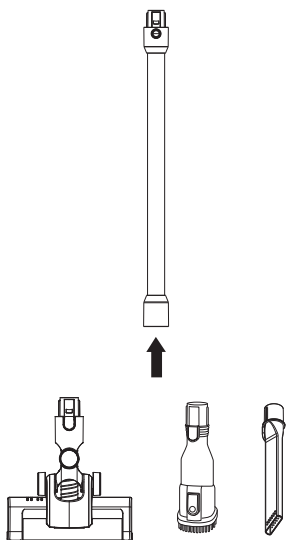

Introduction of Components

Easy to store and charge :

(1) Fix the adapter on the wall bracket as per the instruction below.

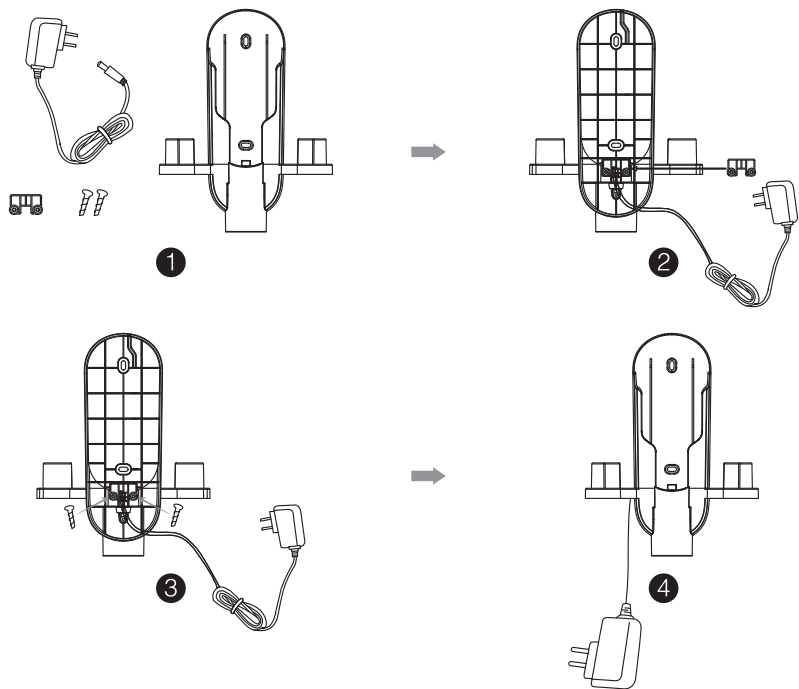

(2) Fix the wall bracket on the wall with expansion screws to hang the vacuum cleaner and storage accessories.

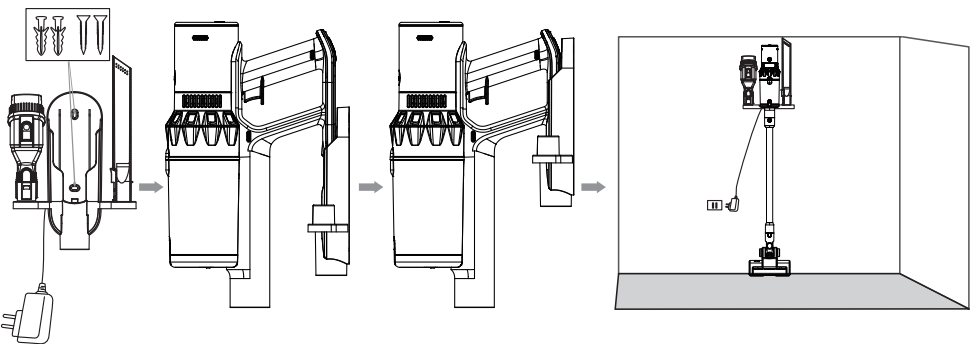

Introduction of Components

II. Use as a hand vacuum cleaner

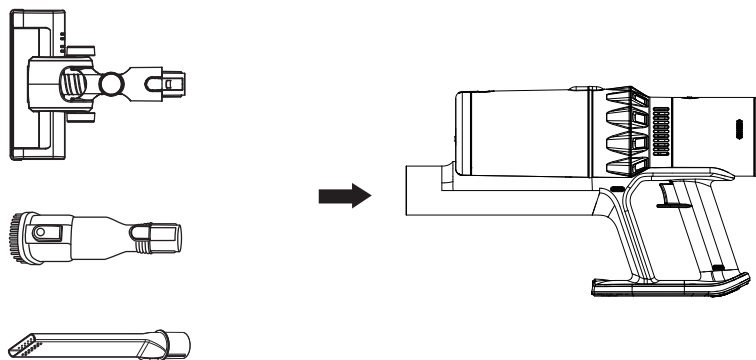

III. Press the switch to work

Three level speed control.

A. First light: It's low speed when you press the switch button first time.

B. Second light: It's middle speed when you press the speed control button first time.

C. Third light: It's high speed when you press the speed control button second time.

Again, back to low speed.

It will be power off when you press the switch button second time.

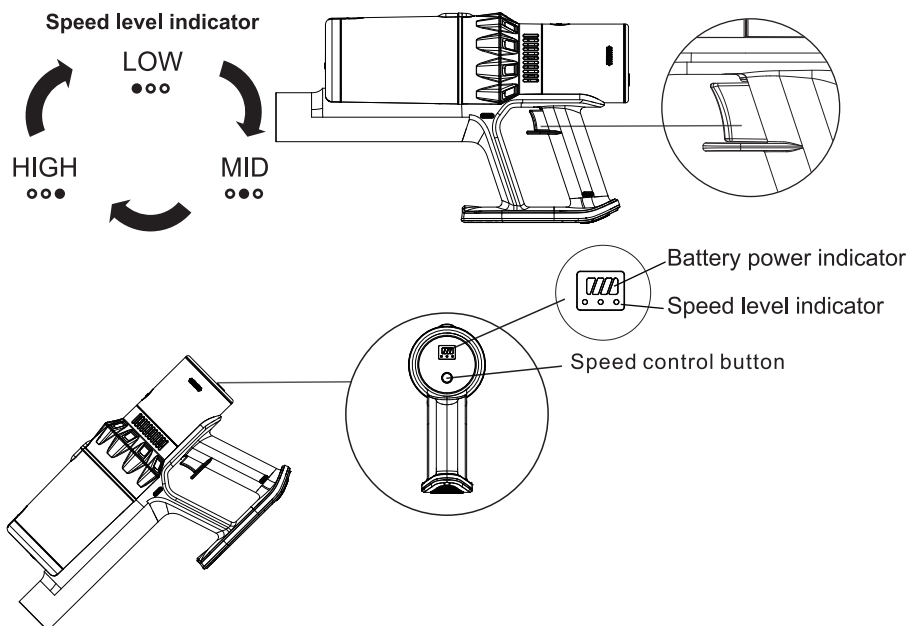

Product Operation

V. Battery charging

- (1) When the last one indicator light of LED display is flashing in green, it indicates that the power is insufficient and needs to be charged. Connect the charger to the power supply and the charging port. It is charging while four indicator lights keep flashing in green.
- (2) The battery is full while four indicator lights are always on green.

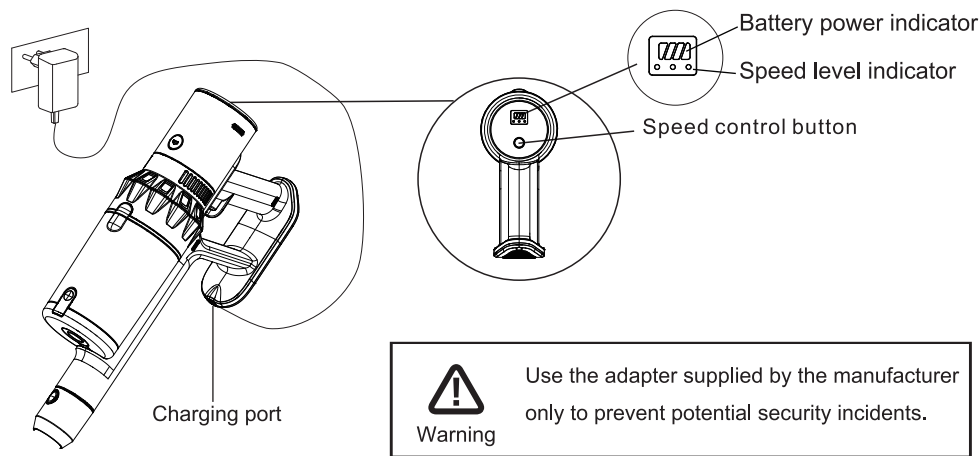

Battery power indicator

In use:



During charging:



→ Recharge the battery pack when the power level is lower than 25%.

VI. How to empty the dust cup

Unlock the dust cup locker

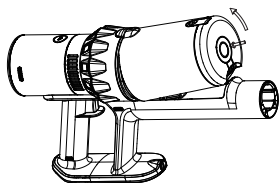

(1)

Empty the dust cup.

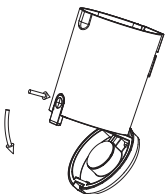

(2)

Product Operation

VII.How to maintain the filter

1.Press the release button to remove the dust cup from mainbody.

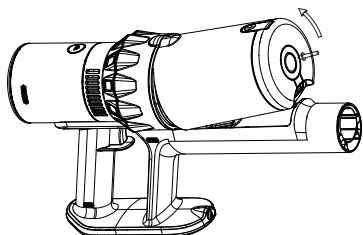

2.Take out the filter case from dust cup.

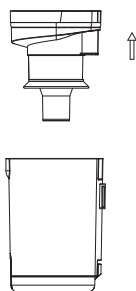

3. Take out the sponge and MIF filter from the case.

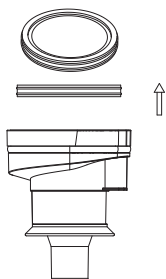

4.Wash the case, sponge and MIF filter.

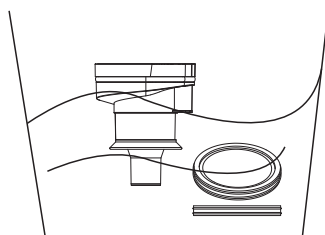

5.Drying case, sponge and MIF filter.

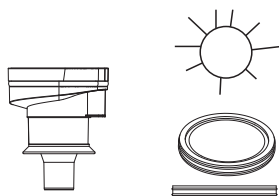

6. Assemble the sponge and MIF filter to the case.

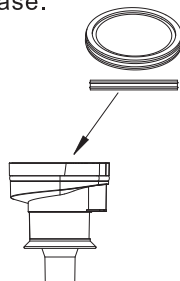

7.Put the filter case back to the dust cup 8. Assemble the dust cup to the mainbody.

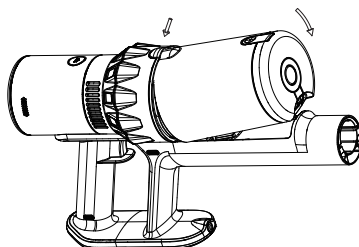
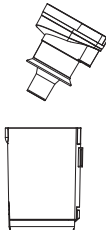

Troubleshooting

Suction gets weak	<ol style="list-style-type: none">1.Empty the dirt cup2.Clean the HEPA filter3.Check if the dirt cup is installed correctly
Roller brush stops spinning & has strange noise	<ol style="list-style-type: none">1.Check if the brush (especially the bearing part) is stuck by hair2.Check if the filter cup is installed correctly in the right place3.Detach the tube, use the handheld part only. If not work, contact the seller for help
Battery doesn't hold a charge	<ol style="list-style-type: none">1.Check if the charger & charging base is connected correctly2.If there is no light on when charging, contact the seller for help3. Check the battery pack was assembled to the mainbody correctly.

For better cleaning performance, we highly suggest cleaning the roller brush regularly after every use.

Specification

Battery capacity	25.9V/2000mAh
Charging time	4-5H
Input voltage	100-240V 50/60Hz
Output voltage	30.0V 0.5A
Working time	12min-50min
Motor power	350 W

DEVANTI®